

# CR - D - xx - xPx - xx

| Hood body construction |                    |
|------------------------|--------------------|
| SW                     | SteelWhite RAL9010 |
| S4                     | SS 304             |
| S6                     | SS 316L            |

| Filter front size |         |
|-------------------|---------|
| 3P3               | 305x305 |
| 3P6               | 305x610 |
| 6P6               | 610x610 |
| 9P6               | 915x610 |

| Door type |   |
|-----------|---|
| F1        | standard door                               |
| F2        | prefilter door<br>(filter depth 48 - 50 mm) |

**3P6**  
Item No. SW / S4 / S6: TBA

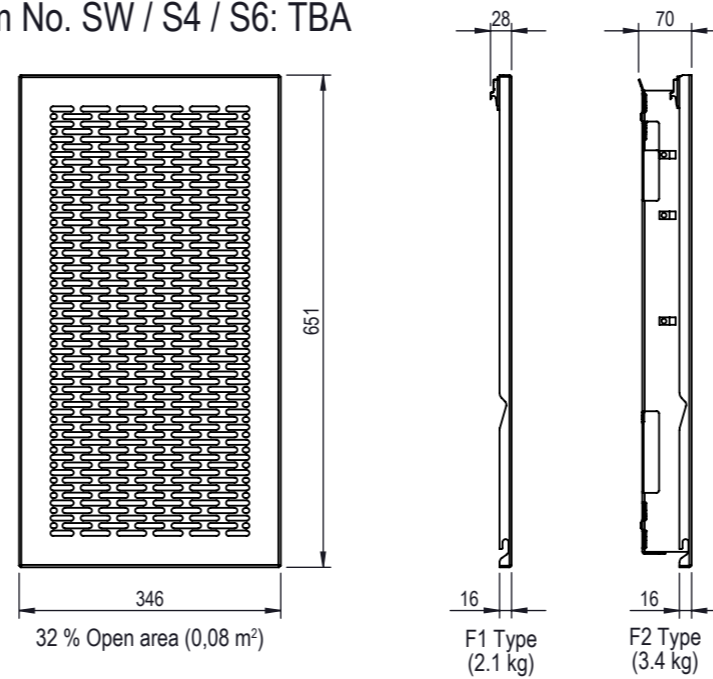

**9P6**  
Item No. SW / S4 / S6: TBA

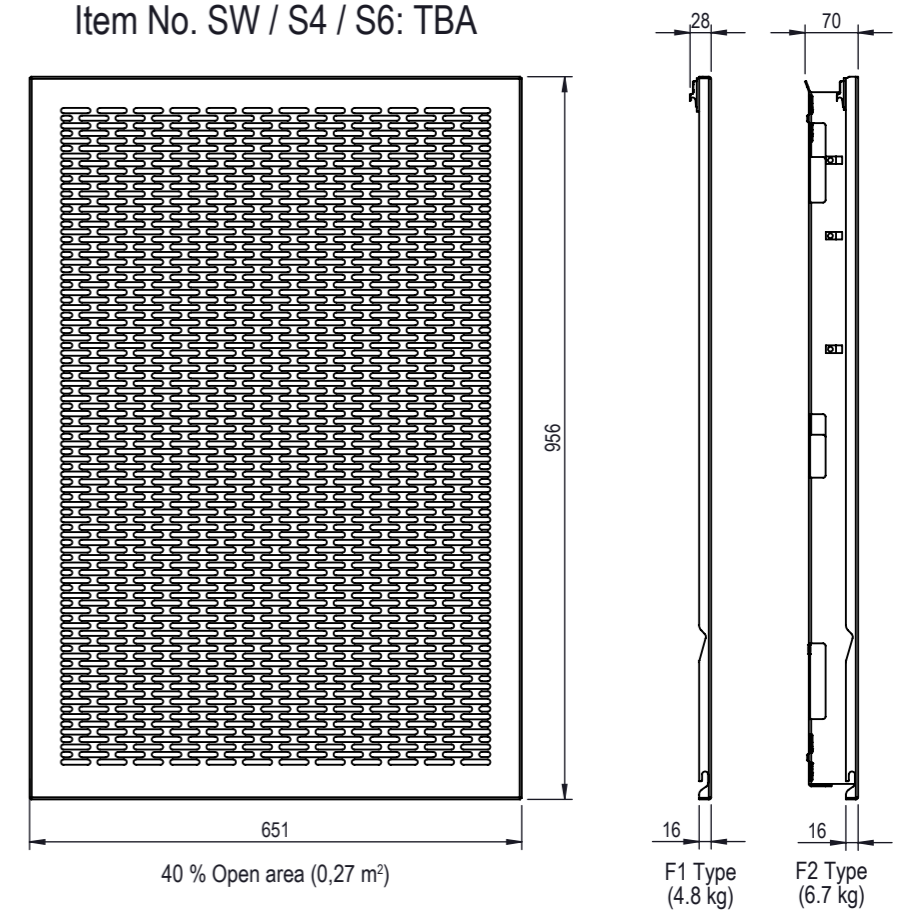

**3P3**  
Item No. SW / S4 / S6: TBA

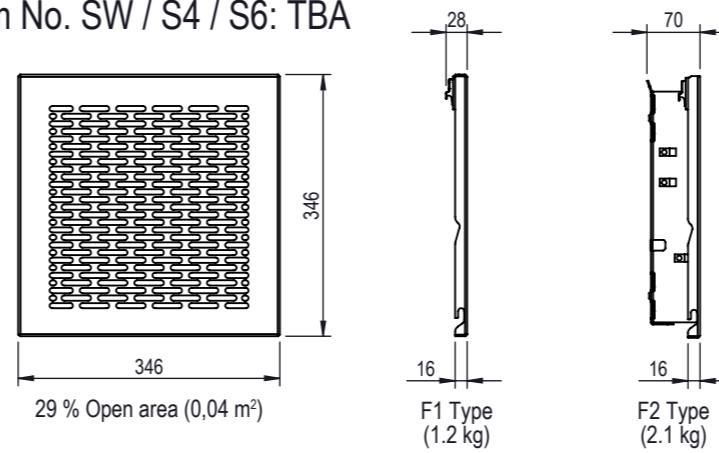

**6P6**  
Item No. SW / S4 / S6: TBA

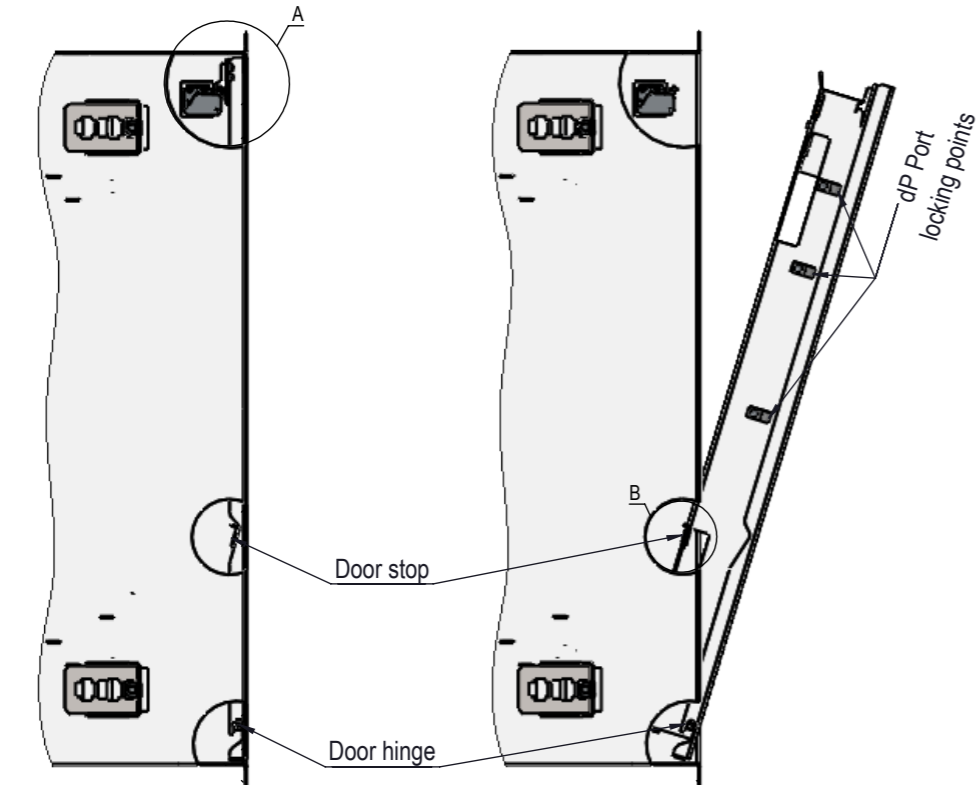
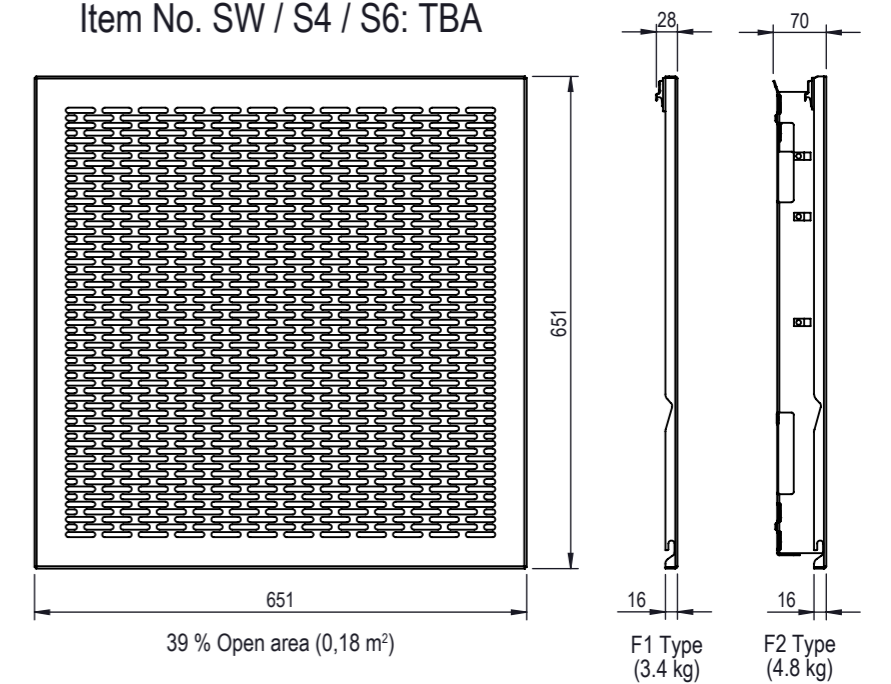

Locked position

Open position  
for prefilter change

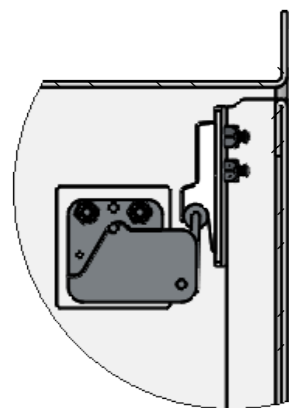

DETAIL A

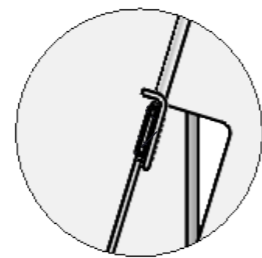

DETAIL B

Standard door  
F1 Type

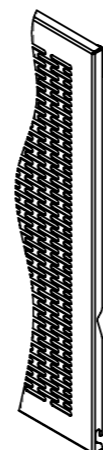

Prefilter door  
F2 Type



|   |                             |                       |               |
|---|-----------------------------|-----------------------|---------------|
| DESCRIPTION<br>CleanSeal Exhaust - Door   |                             |                       |               |
| PROJECT                                   | LAST REVISION<br>11.10.2021 | WEIGHT<br>see drawing |               |
| DRAWING REF.<br>Scope Drawing - CR-Add on | SHEET<br>1/6                | SIZE<br>A3            |               |
|   |                             |                       | SCALE<br>1:10 |

NB: The copyright of this drawing remains with Camfil. Contents must not be used, copied or disclosed to third parties without prior written consent. All rights reserved.

# CL - D - xx - xPx - F2

| Hood body construction |                    |
|------------------------|--------------------|
| SW                     | SteelWhite RAL9010 |
| S4                     | SS 304             |
| S6                     | SS 316L            |

| Filter front size |         |
|-------------------|---------|
| 3P3               | 305x305 |
| 3P6               | 305x610 |
| 5P5               | 508x508 |
| 6P6               | 610x610 |

**3P6**  
Item No. SW / S4 / S6: TBA

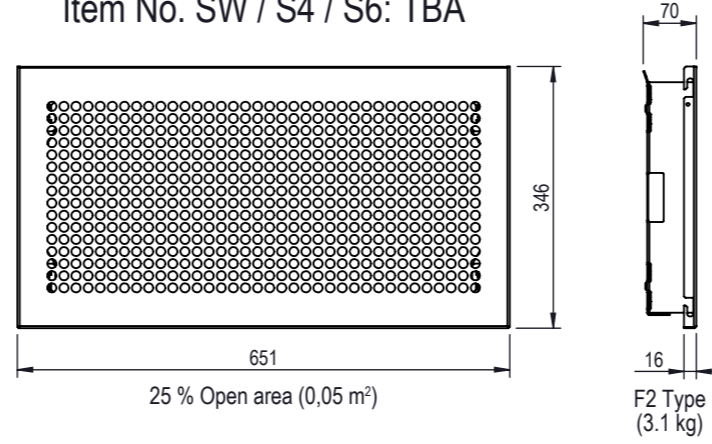

**5P5**  
Item No. SW / S4 / S6: TBA

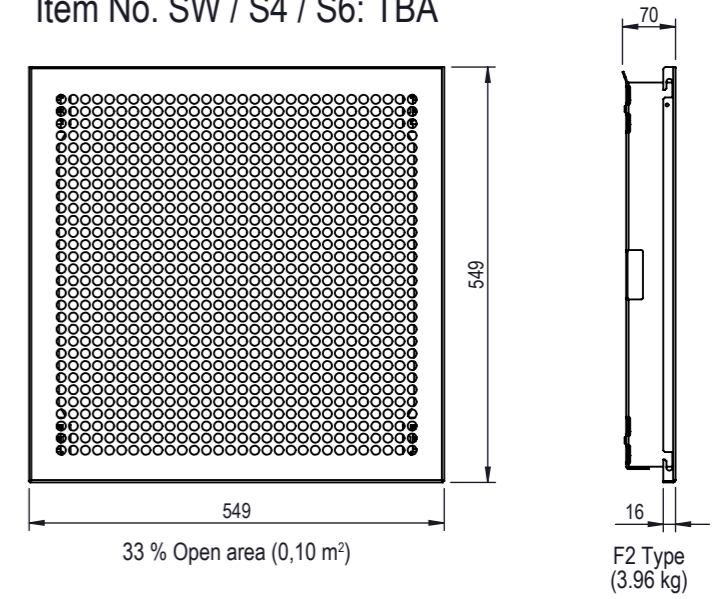

**3P3**  
Item No. SW / S4 / S6: TBA

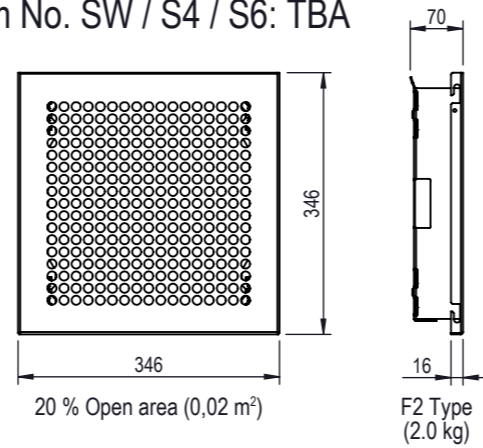

**6P6**  
Item No. SW / S4 / S6: TBA

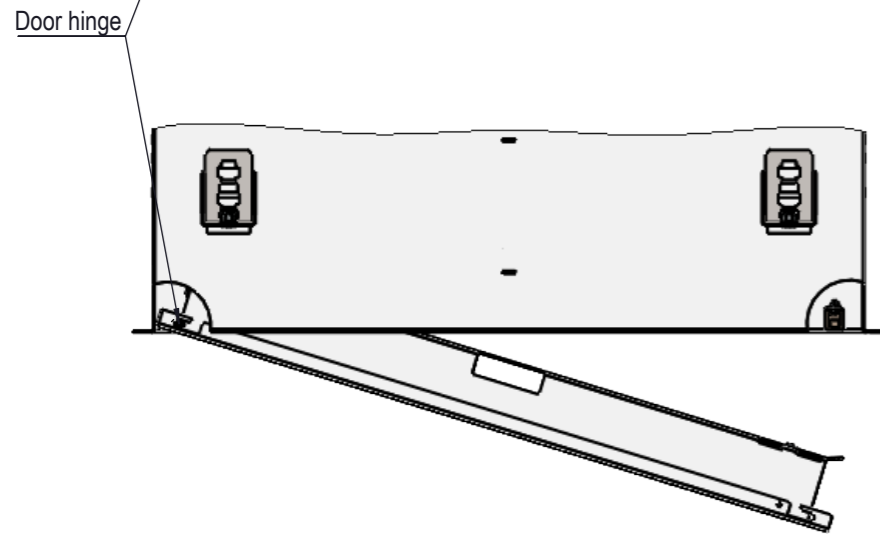
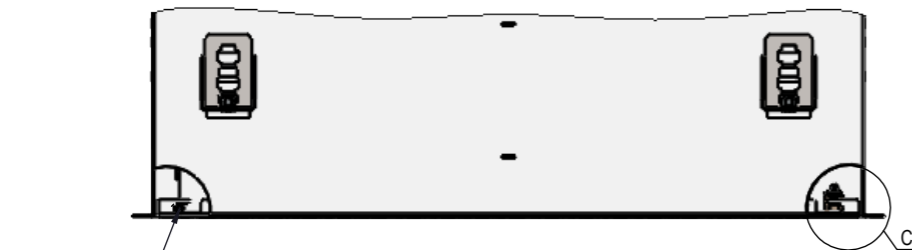
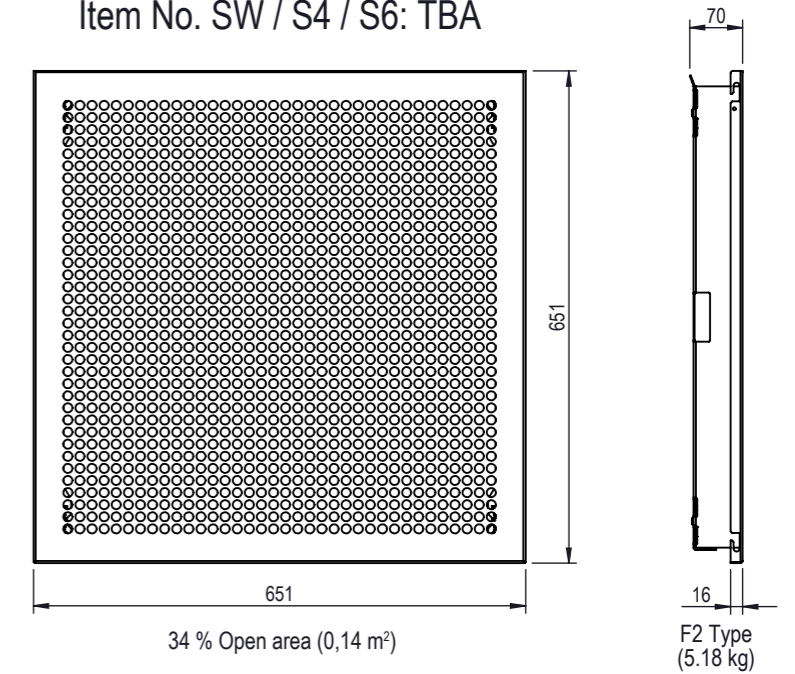

Locked position

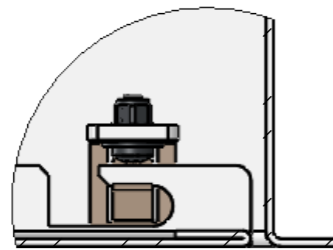

DETAIL C

Prefilter door  
F2 Type



|                           |  |               |        |       |
|---------------------------|--|---------------|--------|-------|
| <br>European Metal Center | DESCRIPTION<br>CleanSeal Exhaust - Front plate |               |        |       |
|                           | PROJECT  | LAST REVISION | WEIGHT |       |
|                           | 11.10.2021                                     | see drawing   |        |       |
|                           | DRAWING REF.                                   | SHEET         | SIZE   | SCALE |
| Scope Drawing - CR-Add on | 2/6  | A3            | 1:10   |       |

NB: The copyright of this drawing remains with Camfil. Contents must not be used, copied or disclosed to third parties without prior written consent. All rights reserved.

# CR - K - S4 - xPx - xx

| Filter front size |     |
|-------------------|-----|
|                   | 3P3 |
|                   | 3P6 |
|                   | 6P6 |
|                   | 9P6 |

| Wall thickness |                         |
|----------------|-------------------------|
| H1             | wall thickness 18-38 mm |
| H2             | wall thickness 34-54 mm |
| H3             | wall thickness 50-70 mm |

| Size | Weight | Wall thickness | Item No. |
|------|--------|----------------|----------|
| 3P3  | 2.9 kg | 18-38mm        | 1076207  |
|      |        | 34-54mm        | 1077069  |
|      |        | 50-70mm        | 1076209  |

| Size | Weight | Wall thickness | Item No. |
|------|--------|----------------|----------|
| 3P6  | 4.2 kg | 18-38mm        | 1076210  |
|      |        | 34-54mm        | 1077070  |
|      |        | 50-70mm        | 1076212  |

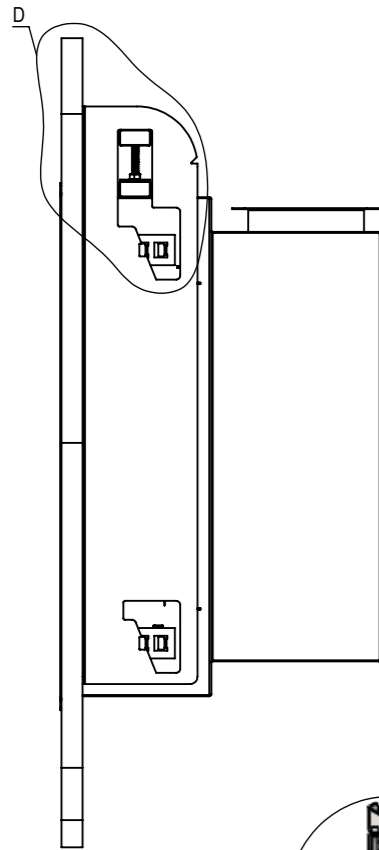

Housing not included

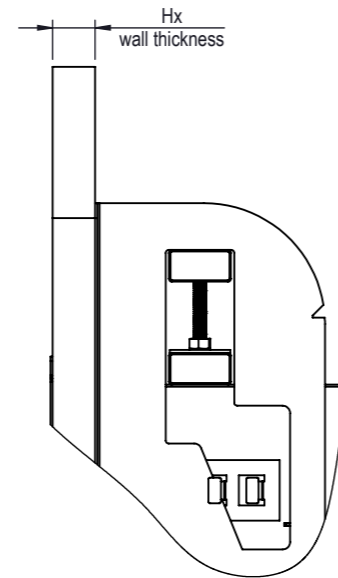

DETAIL D

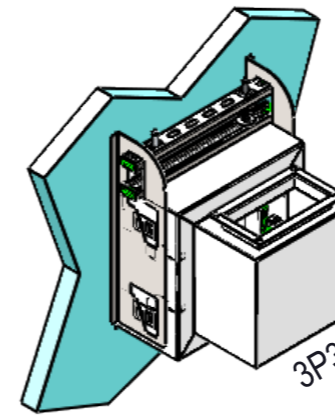

3P3

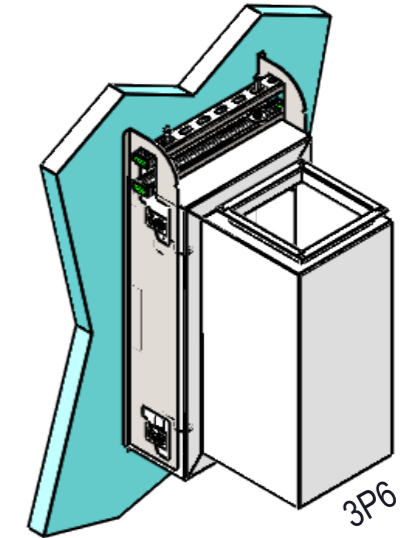

3P6

| Size | Weight | Wall thickness | Item No. |
|------|--------|----------------|----------|
| 9P6  | 5.9 kg | 18-38mm        | 1076216  |
|      |        | 34-54mm        | 1077072  |
|      |        | 50-70mm        | 1076218  |

| Size | Weight | Wall thickness | Item No. |
|------|--------|----------------|----------|
| 6P6  | 4.6 kg | 18-38mm        | 1076213  |
|      |        | 34-54mm        | 1077071  |
|      |        | 50-70mm        | 1076215  |

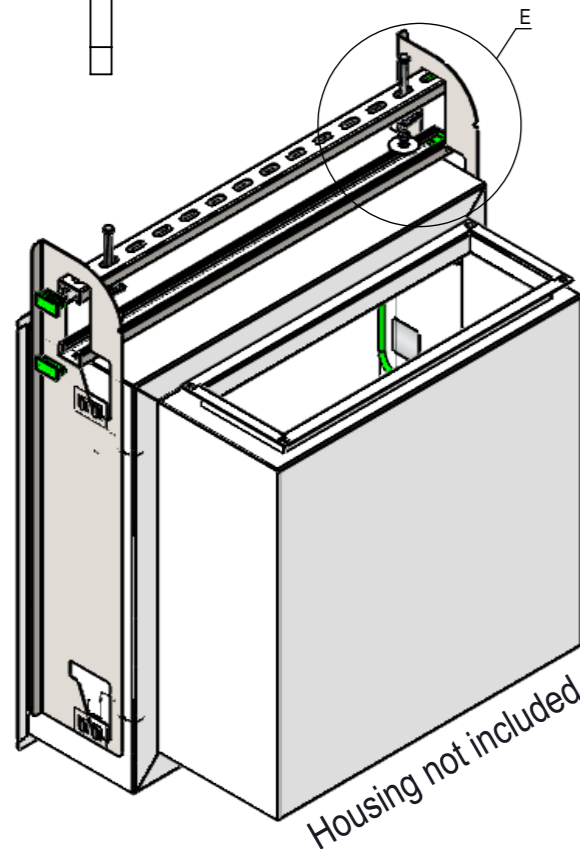

Housing not included

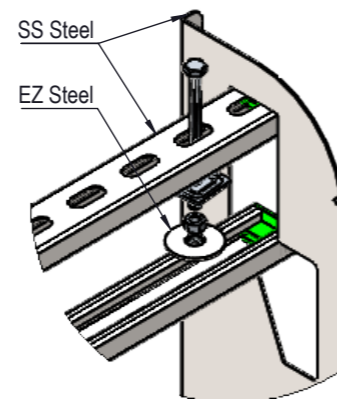

DETAIL E

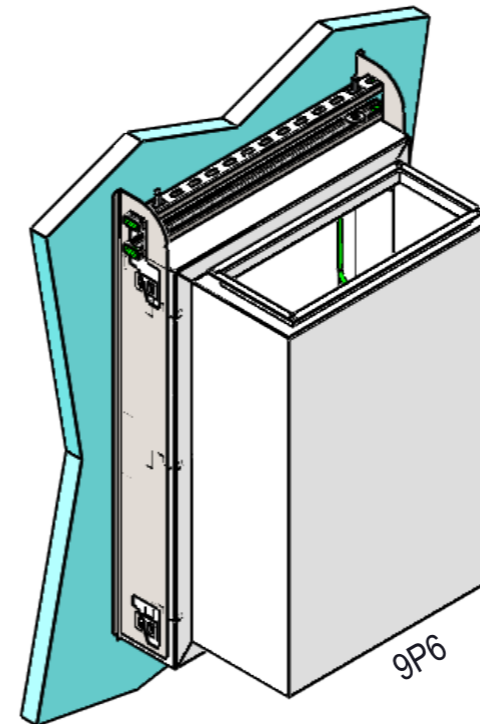

9P6

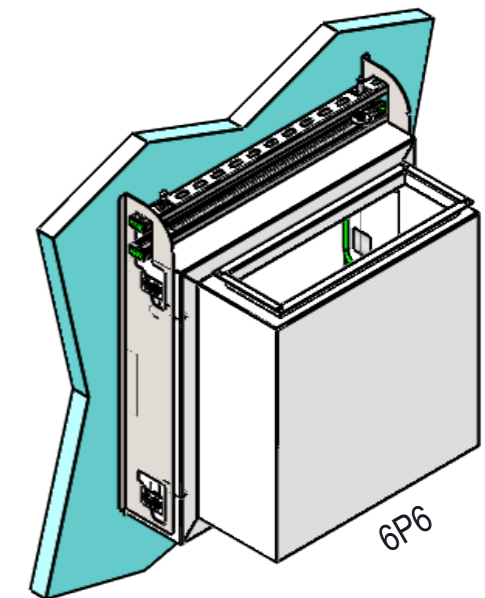

6P6



|   |                             |                       |               |
|---|-----------------------------|-----------------------|---------------|
| DESCRIPTION<br>CleanSeal Exhaust - Clamping kit |                             |                       |               |
| PROJECT   | LAST REVISION<br>11.10.2021 | WEIGHT<br>see drawing |               |
| DRAWING REF.<br>Scope Drawing - CR-Add on       | SHEET<br>3/6                | SIZE<br>A3            |               |
|   |                             |                       | SCALE<br>1:15 |

NB: The copyright of this drawing remains with Camfil. Contents must not be used, copied or disclosed to third parties without prior written consent. All rights reserved.



# CR - A - xx - R - xxxx - C - xxxx

| Hood body construction |                                      |
|------------------------|--------------------------------------|
| HZ                     | Hot-dip galvanized sheet steel Z 275 |
| S4                     | SS 304                               |

| Rectangular size |      |
|------------------|------|
|                  | 2010 |
|                  | 2020 |
|                  | 3510 |
|                  | 3515 |
|                  | 4015 |
|                  | 4020 |
|                  | 5015 |
|                  | 5020 |
|                  | 6020 |
|                  | 8015 |

| Circular size |      |
|---------------|------|
|               | 0160 |
|               | 0200 |
|               | 0250 |
|               | 0315 |
|               | 0355 |

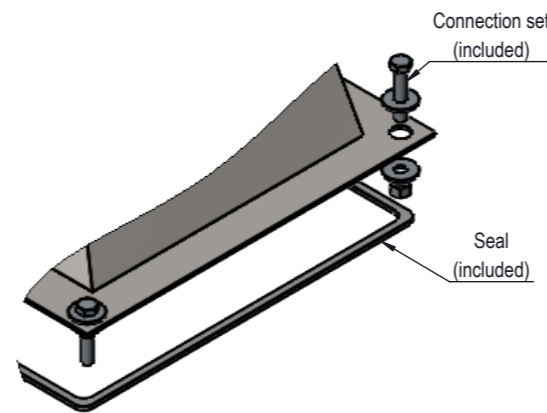
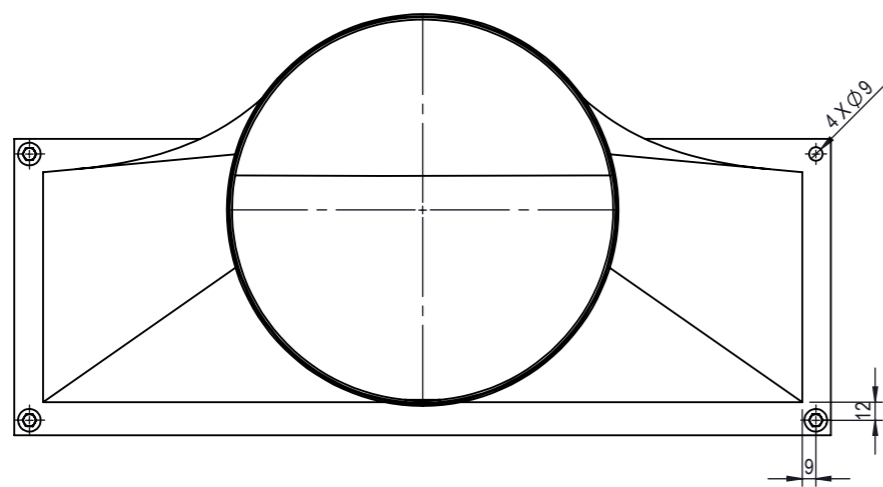
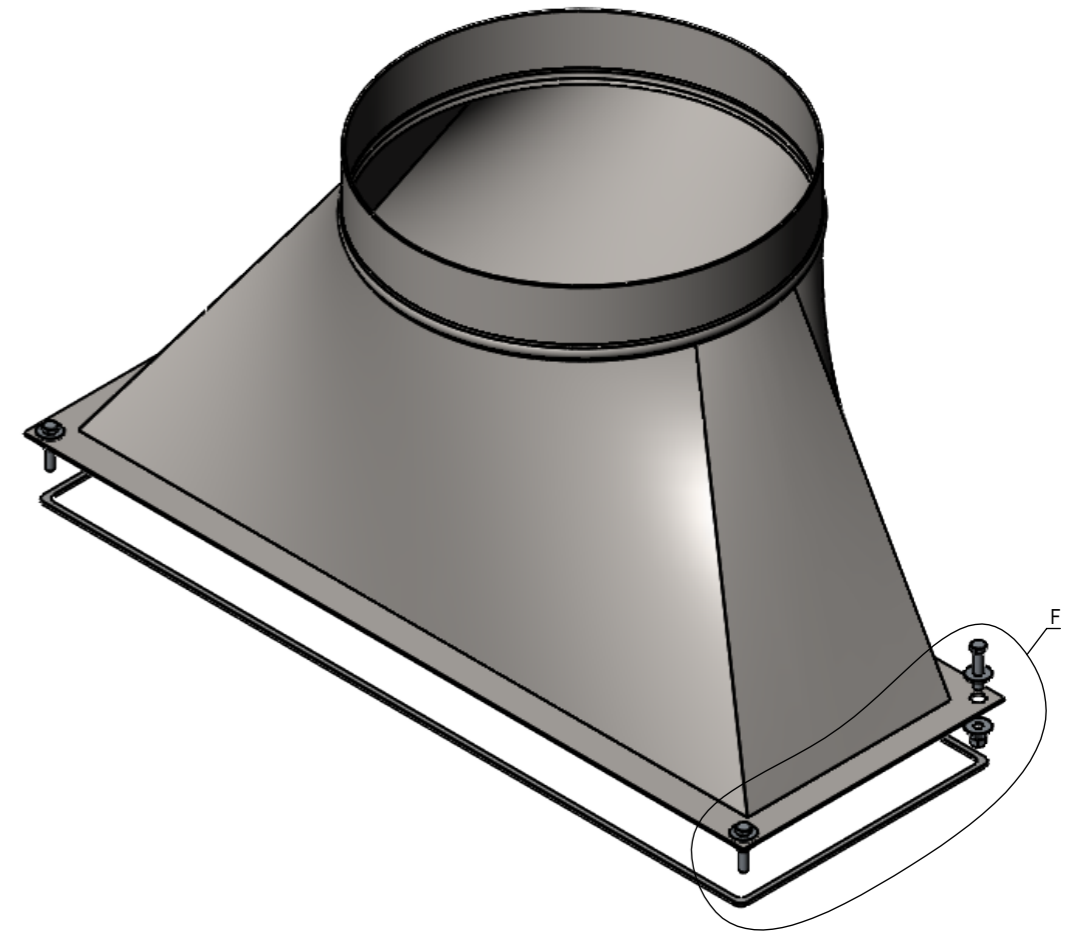
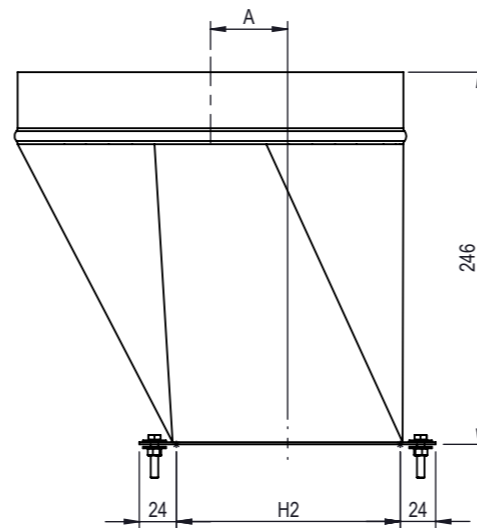
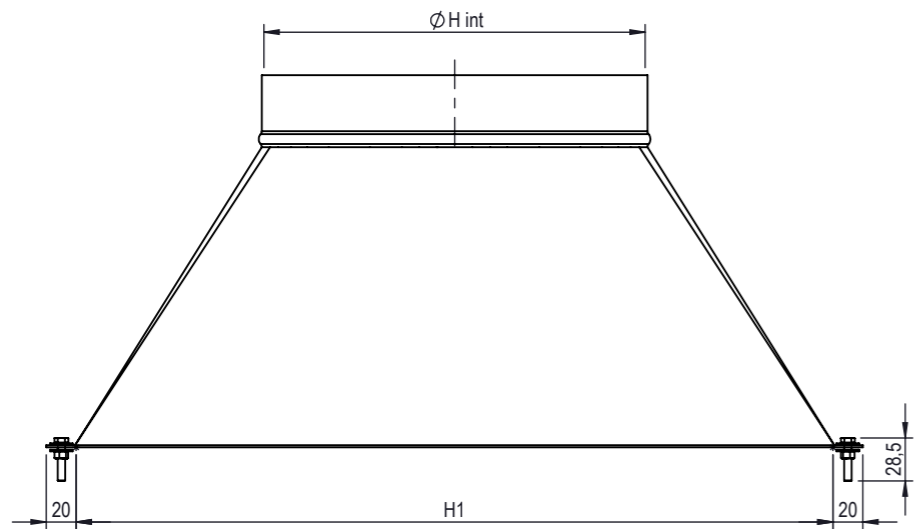

DETAIL F

| Compatible sizes | Rectangular size | CAD Reference      | Item No. (HZ) | Item No. (S4) | H1  | H2  | A     | $\varnothing H_{int}$ | Weight [kg] |
|------------------|------------------|--------------------|---------------|---------------|-----|-----|-------|-----------------------|-------------|
| 3P3              | 200x100          | CR-A-R-2010-C-0160 | TBA           | TBA           | 200 | 100 | 31    | 162                   | 1.9         |
|                  |                  | CR-A-R-2010-C-0200 | TBA           | TBA           |     |     | 51    | 202                   | 2.1         |
| 3P6              | 200x200          | CR-A-R-2020-C-0200 | TBA           | TBA           | 200 | 200 | 1     | 202                   | 2.4         |
|                  |                  | CR-A-R-2020-C-0250 | TBA           | TBA           |     |     | 26    | 252                   | 2.6         |
| 4P4              | 350x100          | CR-A-R-3510-C-0200 | TBA           | TBA           | 350 | 100 | 51    | 202                   | 2.6         |
|                  |                  | CR-A-R-3510-C-0250 | TBA           | TBA           |     |     | 76    | 252                   | 2.8         |
| 5P5              | 350x150          | CR-A-R-3515-C-0200 | TBA           | TBA           | 350 | 150 | 51    | 202                   | 2.7         |
|                  |                  | CR-A-R-3515-C-0250 | TBA           | TBA           |     |     | 51    | 252                   | 3.0         |
| 11P5             | 400x150          | CR-A-R-4015-C-0250 | TBA           | TBA           | 400 | 150 | 51    | 252                   | 3.1         |
|                  |                  | CR-A-R-4015-C-0315 | TBA           | TBA           |     |     | 83,5  | 317                   | 3.6         |
| 6P6              | 400x200          | CR-A-R-4020-C-0315 | TBA           | TBA           | 400 | 200 | 58,5  | 317                   | 3.7         |
|                  |                  | CR-A-R-4020-C-0355 | TBA           | TBA           |     |     | 78,5  | 357                   | 3.9         |
| 9P6 / 12P6       | 500x150          | CR-A-R-5015-C-0250 | TBA           | TBA           | 500 | 150 | 51    | 252                   | 3.5         |
|                  |                  | CR-A-R-5015-C-0315 | TBA           | TBA           |     |     | 83,5  | 317                   | 3.9         |
| 9P6 / 9P9        | 500x200          | CR-A-R-5020-C-0315 | TBA           | TBA           | 500 | 200 | 58,5  | 317                   | 4.0         |
|                  |                  | CR-A-R-5020-C-0355 | TBA           | TBA           |     |     | 78,5  | 357                   | 4.3         |
| 11P5 / 12P6      | 600x200          | CR-A-R-6020-C-0315 | TBA           | TBA           | 600 | 200 | 58,5  | 317                   | 4.4         |
|                  |                  | CR-A-R-6020-C-0355 | TBA           | TBA           |     |     | 78,5  | 357                   | 4.7         |
|                  | 800x150          | CR-A-R-8015-C-0315 | TBA           | TBA           | 800 | 150 | 83,5  | 317                   | 5.1         |
|                  |                  | CR-A-R-8015-C-0355 | TBA           | TBA           |     |     | 103,5 | 357                   | 5.5         |

**NOTE:**  
Seals are made from temperature resistant polythene.  
Recommended temperature range is -70 to +80°C.



| DESCRIPTION                  |               |        |       |
|------------------------------|---------------|--------|-------|
| CleanSeal Exhaust - Adaptors |               |        |       |
| PROJECT                      | LAST REVISION | WEIGHT |       |
| 11.10.2021                   | see drawing   |        |       |
| DRAWING REF.                 | SHEET         | SIZE   | SCALE |
| Scope Drawing - CR-Add on    | 4/6           | A3     | 1:5   |

NB: The copyright of this drawing remains with Camfil. Contents must not be used, copied or disclosed to third parties without prior written consent. All rights reserved.

# CR - xx - S4 - xPx

| Application |                    |
|-------------|--------------------|
| SW          | 3P3, 3P6, 6P6      |
| SC          | 3P3, 3P6, 5P5, 6P6 |

| Filter front size |     |
|-------------------|-----|
|                   | 3P3 |
|                   | 3P6 |
|                   | 5P5 |
|                   | 6P6 |

SW - wall shroud mounting frame

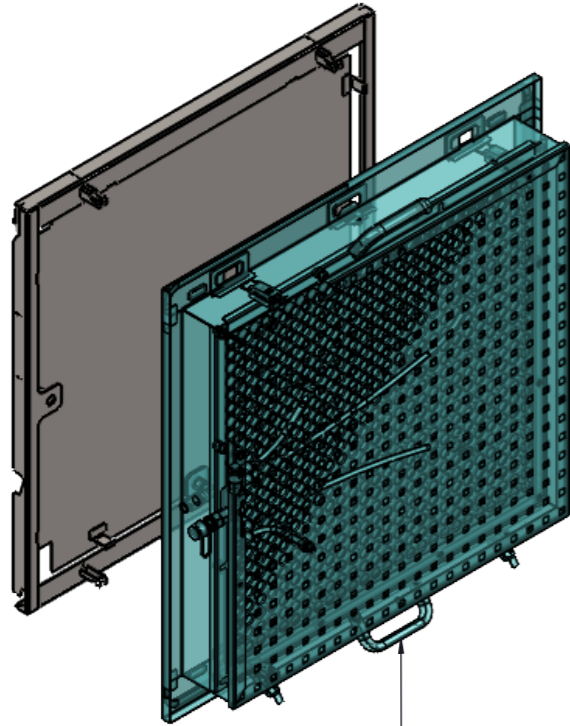

To be ordered separately, see table TESTING SHROUD

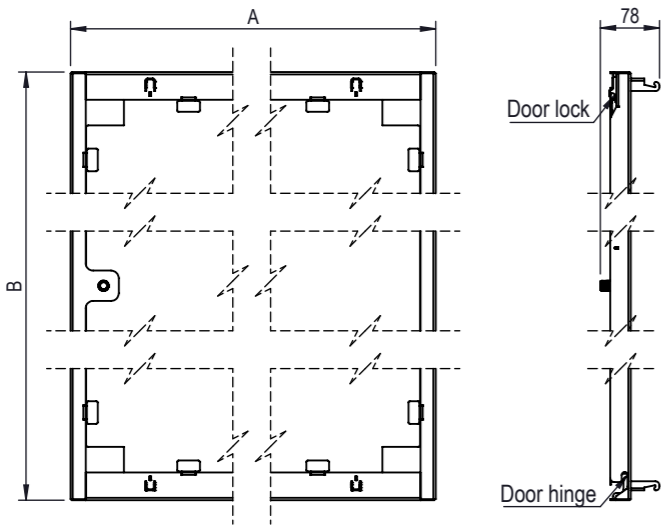

## WALL / CEILING SHROUD MOUNTING FRAME

|     | CAD Reference | Item No. | A   | B   | Weight [kg] |
|-----|---------------|----------|-----|-----|-------------|
| 3P3 | CR-SW-3P3-A   | TBA      | 346 | 346 | 1.6         |
|     | CR-SC-3P3-W   | TBA      |     |     |             |
| 3P6 | CR-SW-3P6-A   | TBA      | 346 | 651 | 2.7         |
|     | CR-SC-3P6-W   | TBA      |     |     |             |
| 5P5 | CR-SC-5P5-W   | TBA      | 549 | 549 | 3.5         |
| 6P6 | CR-SW-6P6-A   | TBA      | 651 | 651 | 4.7         |
|     | CR-SC-6P6-W   | TBA      |     |     |             |

SC - ceiling shroud mounting frame

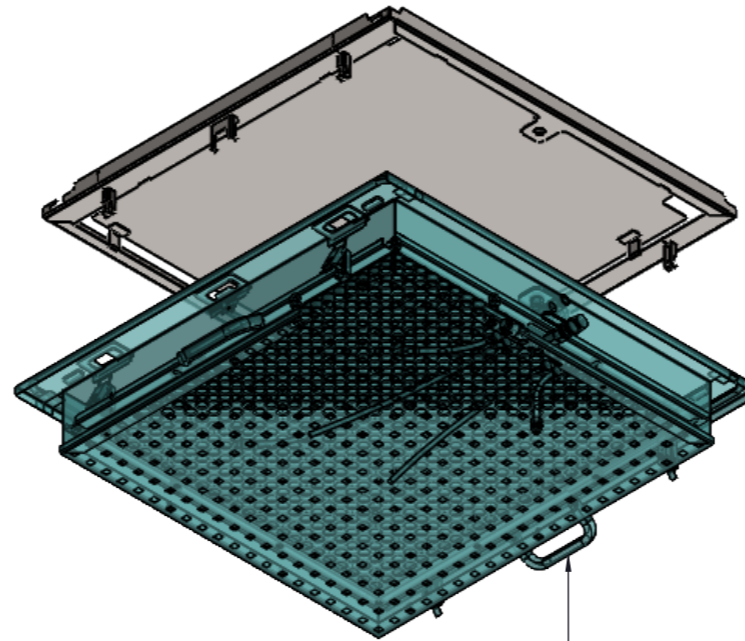

To be ordered separately, see table TESTING SHROUD

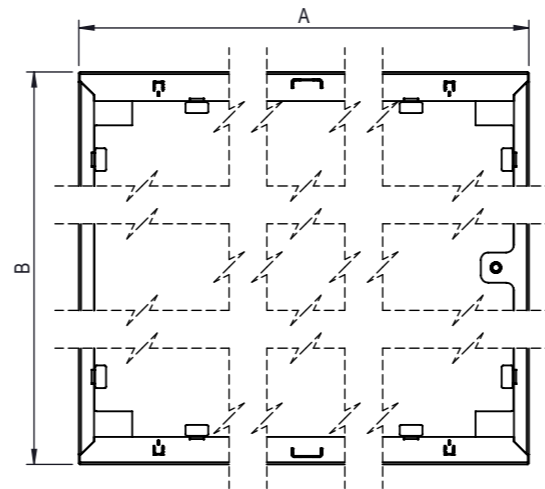

# CR - S - S4 - xPx

| Filter front size |     |
|-------------------|-----|
|                   | 3P3 |
|                   | 3P6 |
|                   | 5P5 |
|                   | 6P6 |

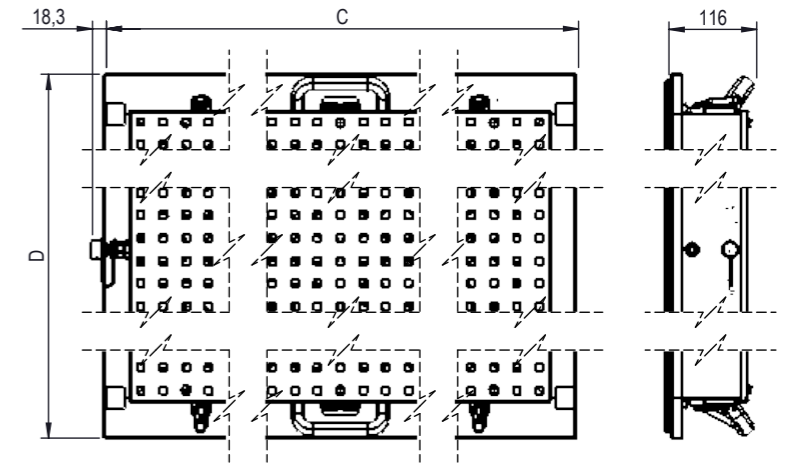
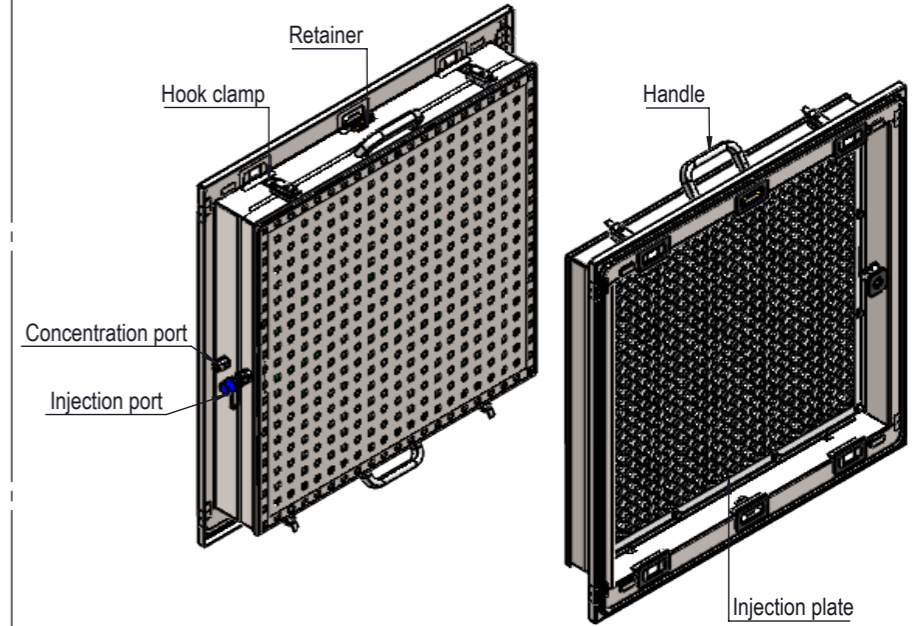

## TESTING SHROUD

|     | CAD Reference | Item No. | C   | D   | Weight [kg] |
|-----|---------------|----------|-----|-----|-------------|
| 3P3 | CR-S-3P3-A    | TBA      | 392 | 392 | 4.6         |
| 3P6 | CR-S-3P6-A    | TBA      | 697 | 392 | 6.8         |
| 5P5 | CR-S-5P5-A    | TBA      | 595 | 595 | 8.0         |
| 6P6 | CR-S-6P6-A    | TBA      | 697 | 697 | 10.1        |



|   |                             |                       |               |
|---|-----------------------------|-----------------------|---------------|
| DESCRIPTION<br>CleanSeal Exhaust - Shroud mounting frame & Testing shroud |                             |                       |               |
| PROJECT   | LAST REVISION<br>11.10.2021 | WEIGHT<br>see drawing |               |
| DRAWING REF.<br>Scope Drawing - CR-Add on                                 | SHEET<br>5/6                | SIZE<br>A3            | SCALE<br>1:10 |

NB: The copyright of this drawing remains with Camfil. Contents must not be used, copied or disclosed to third parties without prior written consent. All rights reserved.

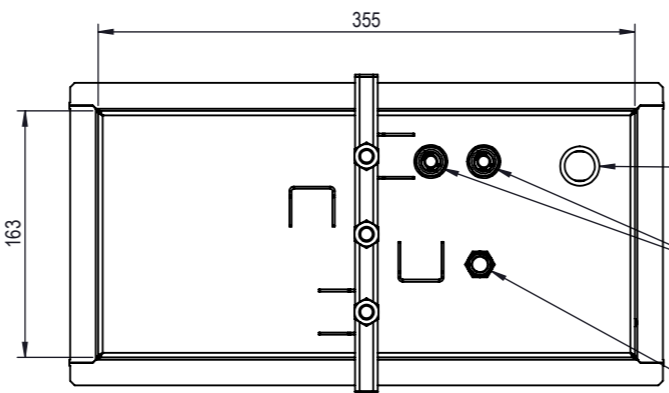
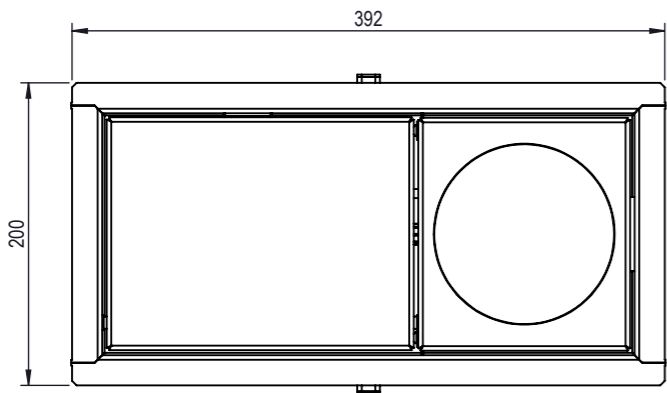

Use copper washer to seal connection between control box and flexible shaft (included)

dP port:  
PU tube 8 x 6 mm compatible (3000 mm included)

Scan sampling port  
Silicone hose 6 x 10 mm compatible (1500 mm included)

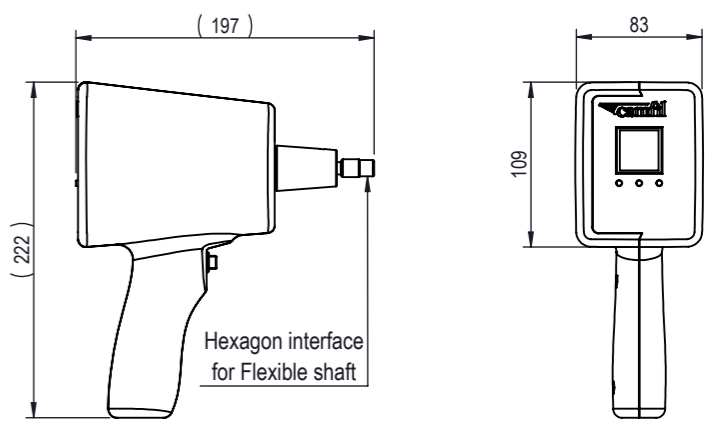

MIP Drive tool  
Item No.: 1086894  
(Box included)

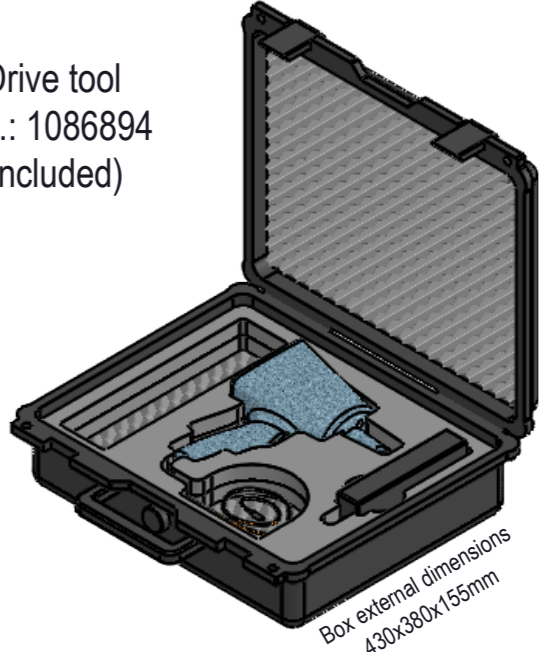

Box external dimensions  
430x380x155mm

For wall thickness < 105 mm adequate spacer to be used

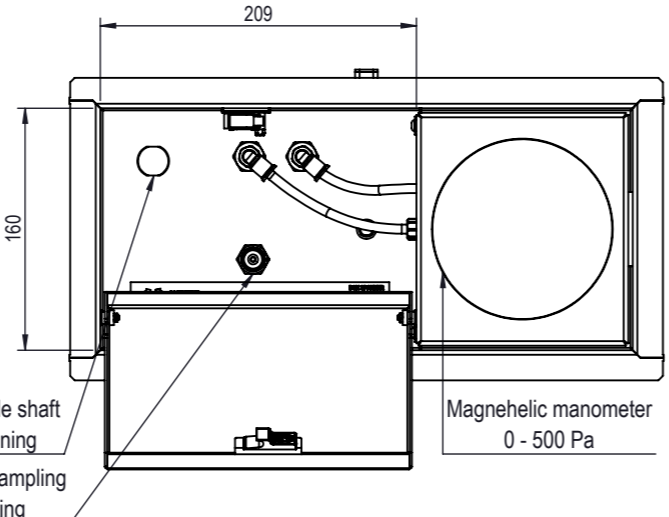
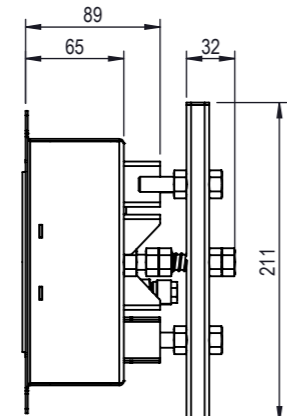
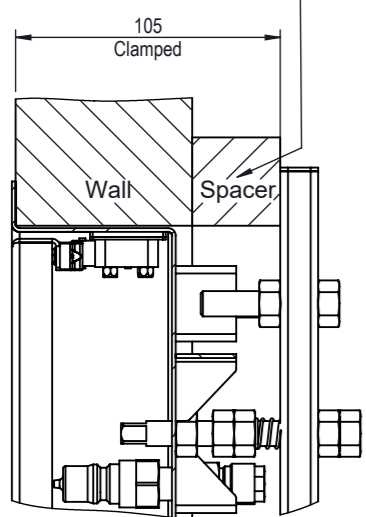

Control box assembly  
Item No. SW: 1087115  
S4: 1087117  
S6: 1087118  
Weight: 3.86 kg

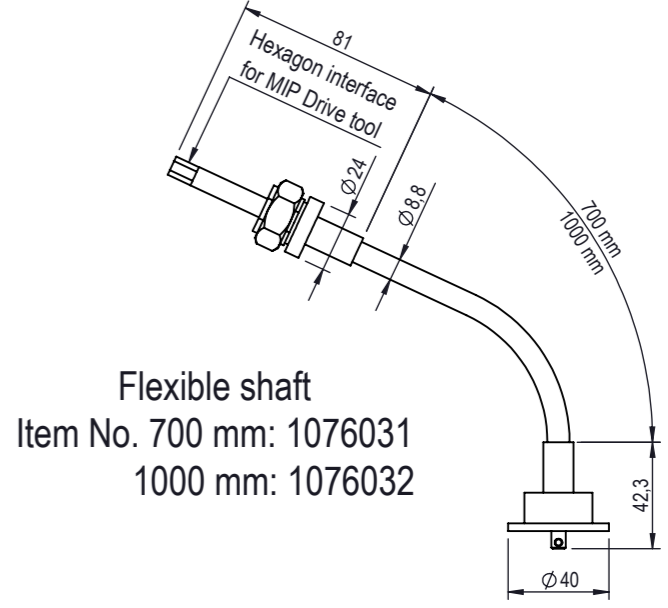

Flexible shaft  
Item No. 700 mm: 1076031  
1000 mm: 1076032

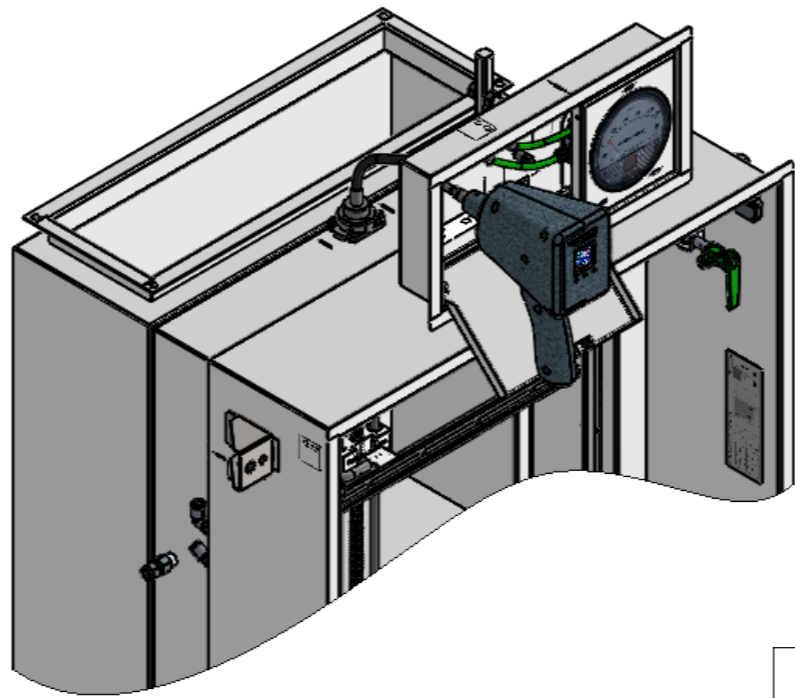
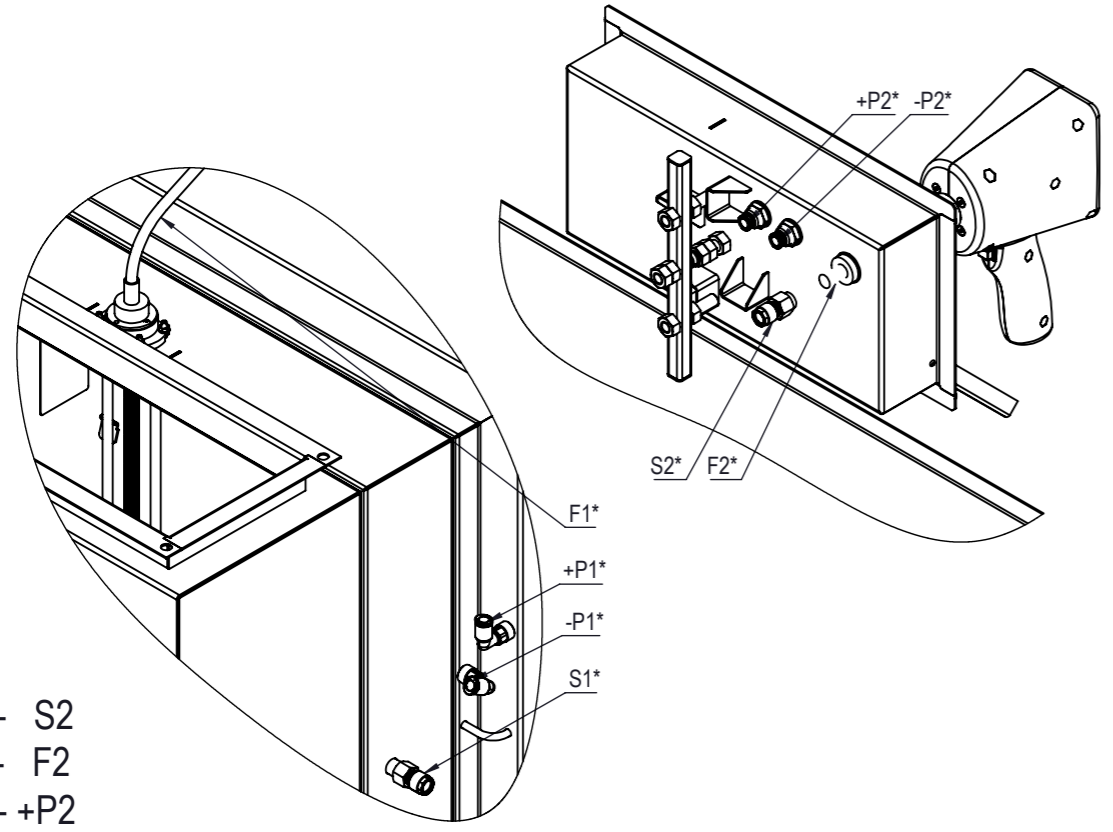

- S1 - S2
- F1 - F2
- +P1 - +P2
- P1 - -P2

\* to be connected together with accessories supplied with Control box

NB: The copyright of this drawing remains with Camfil. Contents must not be used, copied or disclosed to third parties without prior written consent. All rights reserved.

|                              |   |                             |                       |  |
|------------------------------|---|-----------------------------|-----------------------|--|
| <p>European Metal Center</p> | DESCRIPTION<br>CleanSeal Exhaust - Control box & Flexible shaft & MIP Drive |                             |                       |  |
|                              | PROJECT   | LAST REVISION<br>11.10.2021 | WEIGHT<br>see drawing |  |
|                              | DRAWING REF.<br>Scope Drawing - CR-Add on                                   | SHEET<br>6/6                | SIZE<br>A3            |  |